

FileDate.tbl  
 \$DATE  
 K:\WASTE\NORLAKE\10118800\_010 Small.dgn  
 DGN LEVEL

•LEV12  
 •LEV09  
 •LEV03

•LEV12  
 •LEV09  
 •LEV03

•LEV12  
 •LEV09  
 •LEV03

•LEV12  
 •LEV09  
 •LEV03

•LEV12  
 •LEV09  
 •LEV03

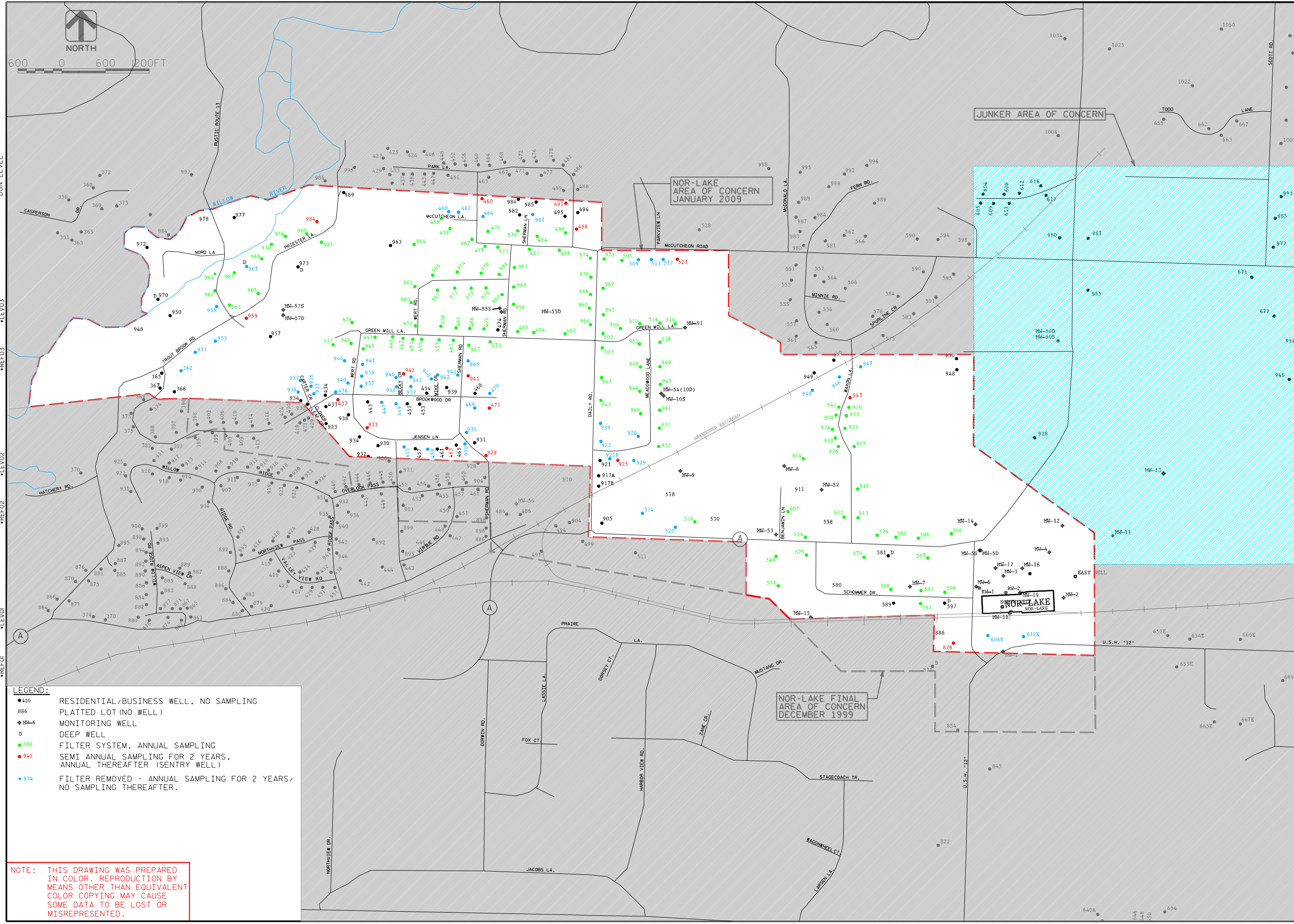

**LEGEND:**

- 420 RESIDENTIAL/BUSINESS WELL, NO SAMPLING
- 886 PLATTED LOT (NO WELL)
- ◆ MW-6 MONITORING WELL
- D DEEP WELL
- 596 FILTER SYSTEM, ANNUAL SAMPLING
- 942 SEMI ANNUAL SAMPLING FOR 2 YEARS, ANNUAL THEREAFTER (SENTRY WELL)
- 974 FILTER REMOVED - ANNUAL SAMPLING FOR 2 YEARS, NO SAMPLING THEREAFTER.

**NOTE:** THIS DRAWING WAS PREPARED IN COLOR. REPRODUCTION BY MEANS OTHER THAN EQUIVALENT COLOR COPYING MAY CAUSE SOME DATA TO BE LOST OR MISREPRESENTED.

**NOR-LAKE AREA OF CONCERN  
 SAMPLING REGIME  
 JANUARY 2009**

DRN. BY: J.G. SCHMIDT  
 CHK. BY: L.A. ROSEMORE  
 DATE: DEC 2008



**NOR-LAKE, INC.  
 HUDSON, WISCONSIN**